

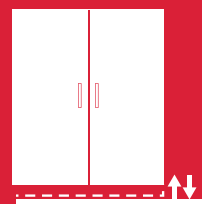

# Integrato with Zinc Alloy Foot



LEVELLERS



# SYMBOLS AND FINISHES LEGEND

## SYMBOLS

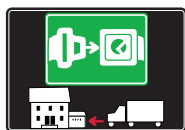

= SHELF SAFELY LOCKED DURING TRANSPORTATION AND AT HOME.



= ANTI-TURNOVER LOCKING SYSTEM



= NORMS / PATENTS



= PHILLIPS / POZIDRIV



= WITH BUFFER



= PART NO.



= BLADE SLOT



= WITH MAGNET



= PCS. PER PACKAGE



= COMBI SLOT



= HEXAGONAL SOCKET



= NEWTON



= CAPACITY LOADING



= HEXALOBULAR SOCKET



= FRICTION



= WOOD / GLASS THICKNESS



= COUNTERSUNK HEAD



= AUTOMATIC



= HOLE DIAMETER



= PAN HEAD



= DROP DOWN



= DIAMETER



= FLANGE HEAD



= LENGTH



= FLAT HEAD



= STANDARD HINGE



= HEIGHT



= TRILOBULAR SCREW



= KIMANA HINGE



= RIGHT VERSION



= SELF-TAPPING SCREW



= FLAP HINGE



= LEFT VERSION



= EURO THREAD



= WITH SPRING



= SETTING CODE



= METRIC THREAD



= WITHOUT SPRING



= PCS. PER PAD



= PRE-INSERTED SCREW



= REVERSED SPRING



= CUT ON REQUEST



= PRE-INSERTED SCREW AND SPREADING BUSH



= SELF ADHESIVE



= WITH FLANGE

NOTE: Printing errors and omissions may exist despite our best efforts to ensure accuracy. We reserve the right to alter specifications without notice.

## MATERIALS

**ZA** = Zinc Alloy

**ST** = Steel

**HSS** = High Speed Steel

**BR** = Brass

**ABS** = Acrylonitrile Butadiene Styrene

**ZAnk** = Nickel-plated Zinc Alloy

**STzk** = Zinc-plated Steel

**AL** = Aluminium

**WD** = Wood

**EVA** = Ethylene Vinyl Acetate

**EP** = **ENGINEERING PLASTIC**

+ **EP** = other engineering plastic available on request

**SR** = **SOFT RUBBER**

+ **SR** = other soft rubber available on request

**EPn** = Natural Engineering Plastic

**EPc** = Clear Engineering Plastic

**SRn** = Natural Soft Rubber

**EPw** = White Engineering Plastic

**EPg** = Grey Engineering Plastic

**SRw** = White Soft Rubber

**EPwg** = Water Green Engineering Plastic

**SRb** = Black Soft Rubber



## FINISHES



+ **OTHER FINISHES AVAILABLE ON REQUEST**

PART NO.	FINISHES	PART NO.	FINISHES	PART NO.	FINISHES
00	Insignificant finish	IF	Middle Grey	UT	T-Met 9007
AA	Natural	IJ	Light Grey	UZ	T-Met
AB	White	IL	Grey 20	WA	Bronzed
AE	White 9010	IN	Grey met. 26	WI	Burnished
EA	Black	JB	Bright Aluminium	XD	Satin-finished Steel
EC	Matt Black	JC	Aluminium - Chrome	YA	Nickel-plated
EE	Anthracite	JD	Matt Aluminium	YB	Bright Nickel-plated
EW	Grey 9007	JE	Satin-finished Aluminium	YC	Matt Nickel-plated
FU	Gunmetal	JF	Aluminium - Brass	YD	Satin-finished Nickel-plated
FV	Gunmetal V52	JG	Aluminium 5	YQ	Black Nickel
GR	Raw	JL	Aluminium PE 11	Z9	Black Zinc
HA	Brass-Plated	JM	Aluminium RAL 9006	ZA	Zinc alloy
HH	Tropicalized	KA	Chrome	ZN	Zinc-plated
HL	Raw Brass	KB	Bright Chrome	ZQ	Bright Gold
HX	Graphite	KC	Matt Chrome	ZY	Titanium
IA	Grey	NN	Metallic Beige	ZZ	Clear
IB	Metallic Grey	RO	Red		



LEVELLERS

# INTEGRATO WITH ZINC ALLOY FOOT

**ITALIANA**  
ferramenta

## INTEGRATO WITH ZINC ALLOY FOOT

INTEGRATO is a complete family of levellers suitable to align heavy duty wardrobes, bookcases and modular furniture. The leveller is installed and safely fixed onto the bottom of the carcase through a wide range of supports such as pins and screw holes, spikes and screw holes or just screw holes.

A further securement in position can be obtained with a countersunk 4x18 mm length screw from underneath first and then with two panhead 3,5x15 mm length screws from the side if required.

The adjustment of the leveller can be carried out from above through a Ø 8 mm hole on the bottom panel, by using a S6mm allen wrench or both cross and blade screwdriver.

The zinc alloy die-cast foot is provided with an independent engineering plastic glide in order to make the adjustment easier and to prevent the scratching of the floor.

A bespoke spacer can be slotted over the leveller to give an extra structural support to the furniture bottom.

The spacer is available in three heights (see the related page).

175 Kg per piece



INTEGRATO levellers are available with 12 mm adjustment and 25 mm adjustment, with main body in zinc alloy or with engineering plastic.

In any case, all versions of INTEGRATO are capable of supporting a 175 kg load each.

*Tested in accordance with CATAS procedures*

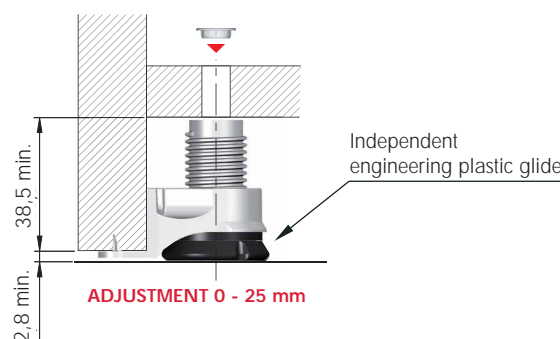
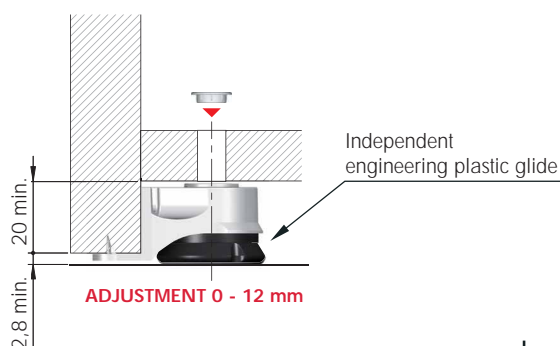

### INSTALLATION

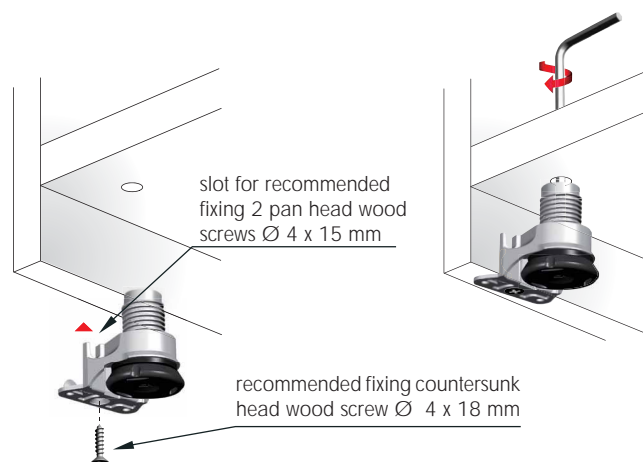
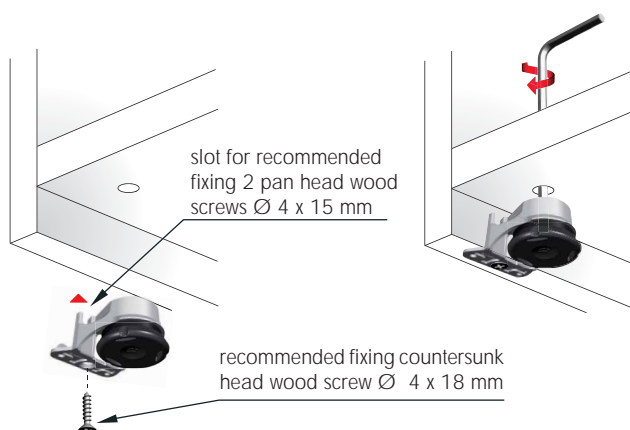

### ADJUSTMENT

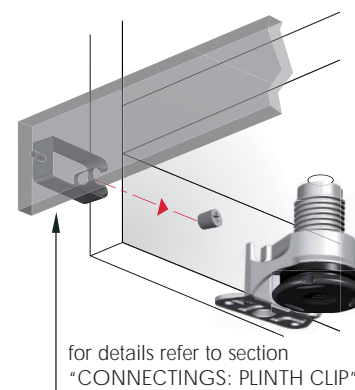
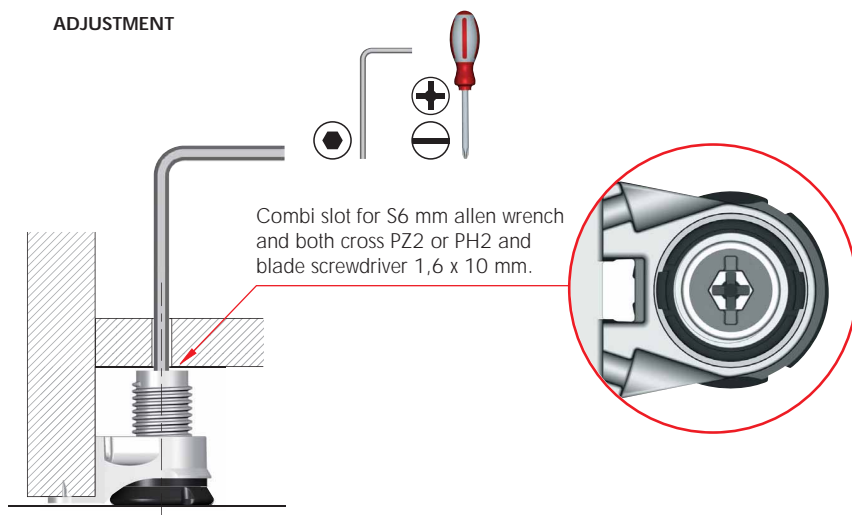

## INTEGRATO A

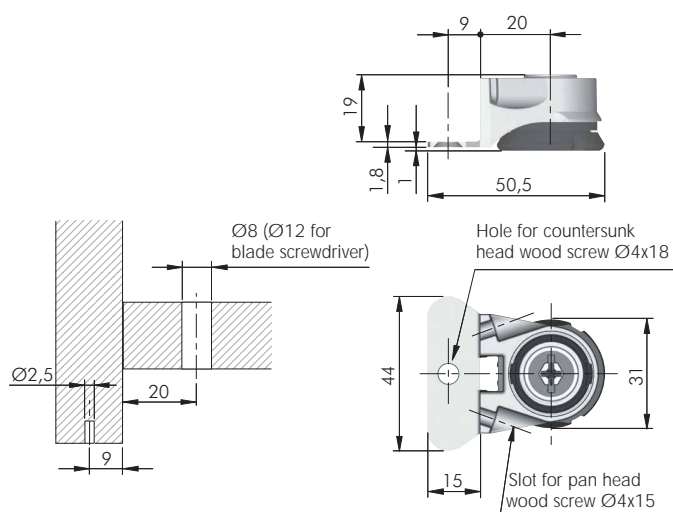

### ADJUSTMENT 0 - 12 mm

ZA EP

= 300 pcs.



3010101000



S6 mm



PZ2 - PH2



1,6x10 mm

3010104000 S4/S6 mm - -

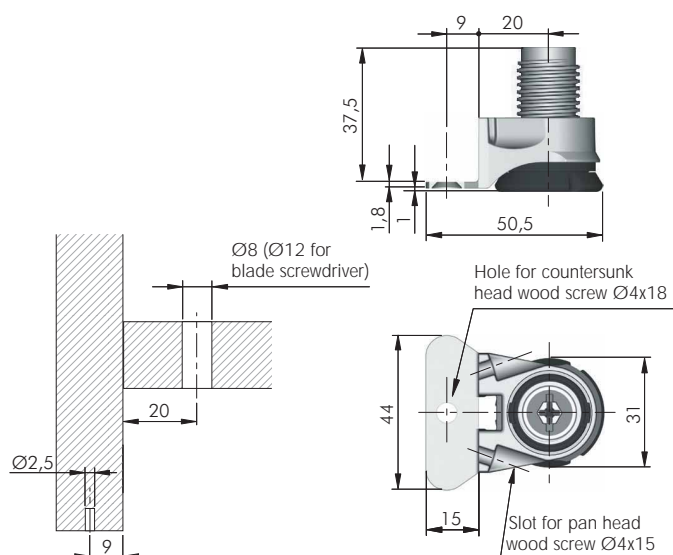

### ADJUSTMENT 0 - 25 mm

ZA EP

= 250 pcs.



3010102000



S6 mm



PZ2 - PH2



1,6x10 mm

3010105000 S4/S6 mm - -



## INTEGRATO B

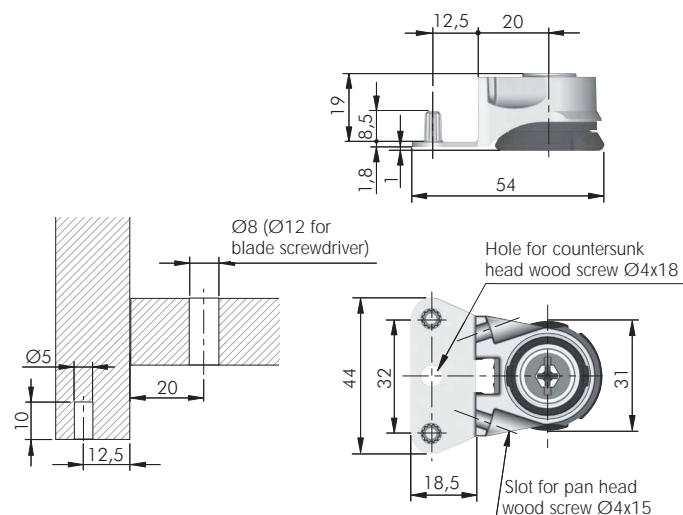

### ADJUSTMENT 0 - 12 mm

ZA EP

= 250 pcs.



3010201000



S6



PZ2 PH2



1,6x10 mm





LEVELLERS

# INTEGRATO WITH ZINC ALLOY FOOT

**ITALIANA**  
ferramenta

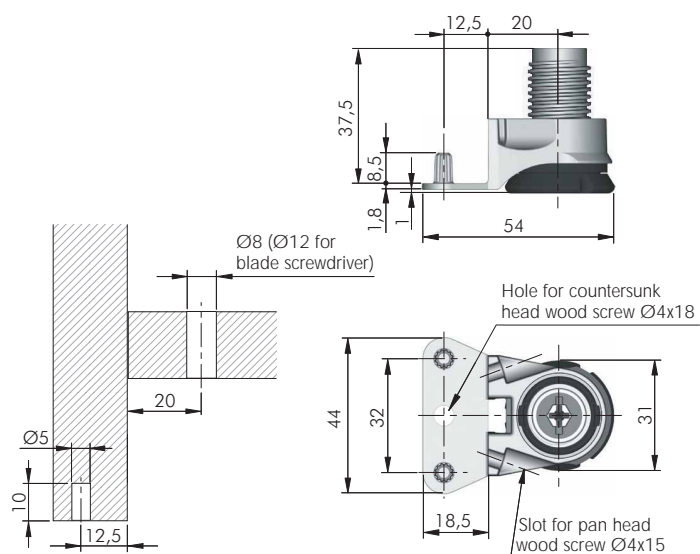

ADJUSTMENT 0 - 25 mm

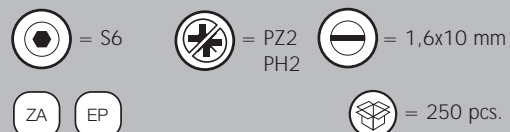

3010202000



## INTEGRATO C

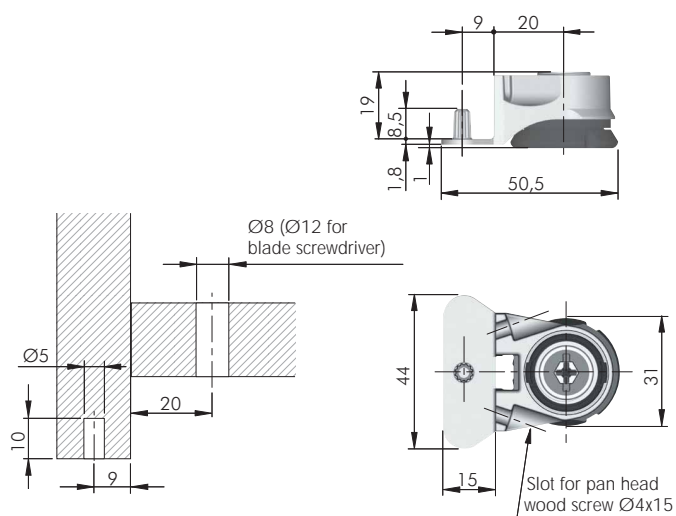

ADJUSTMENT 0 - 12 mm

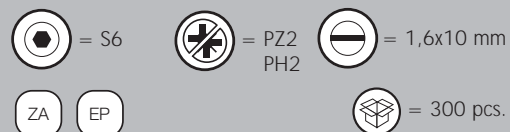

3010301000

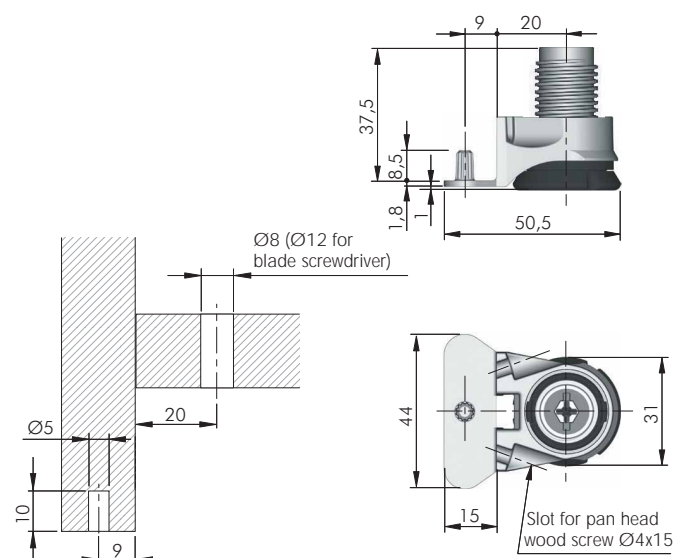
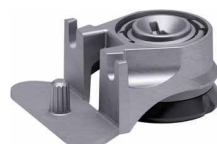

ADJUSTMENT 0 - 25 mm

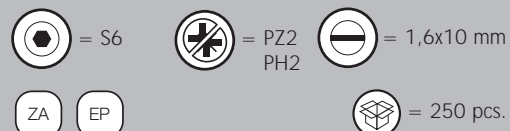

3010302000



## INTEGRATO D

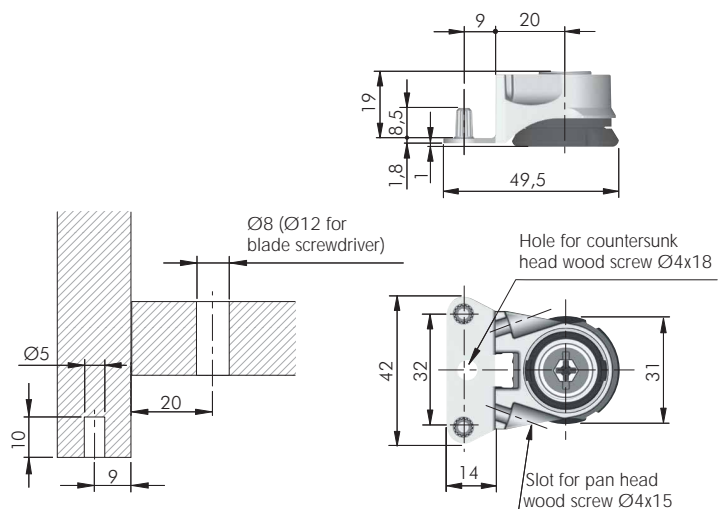

### ADJUSTMENT 0 - 12 mm

ZA	EP	= 300 pcs.		
<b>3010401000</b>		S6 mm	PZ2 - PH2	1,6x10 mm
<b>3010405000</b>		S4/S6 mm	-	-

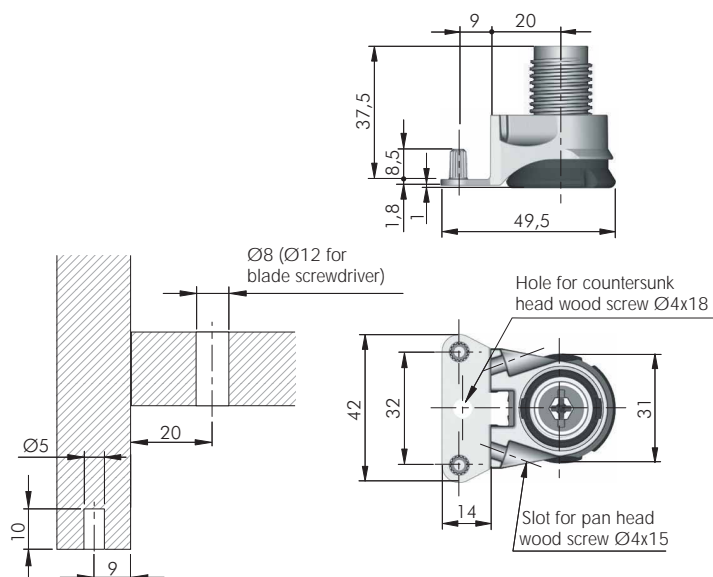







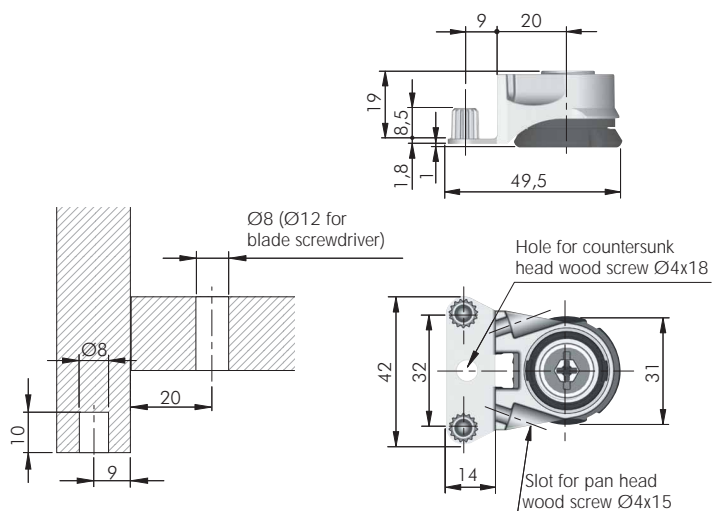

### ADJUSTMENT 0 - 25 mm

ZA	EP	= 250 pcs.		
<b>3010402000</b>		S6 mm	PZ2 - PH2	1,6x10 mm
<b>3010404000</b>		S4/S6 mm	-	-

## INTEGRATO E



### ADJUSTMENT 0 - 12 mm

	= S6		= PZ2 PH2		= 1,6x10 mm
		 = 300 pcs.			
					
<b>3010501000</b>					



LEVELLERS

# INTEGRATO WITH ZINC ALLOY FOOT

**ITALIANA**  
ferramenta

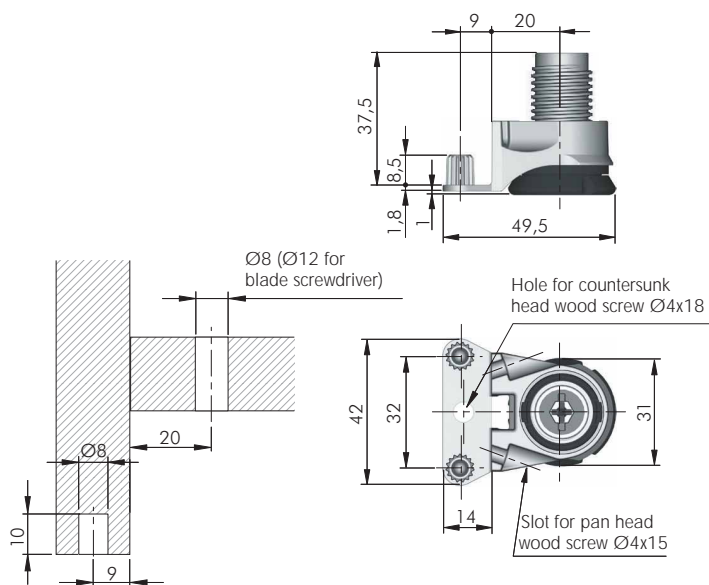

## ADJUSTMENT 0 - 25 mm

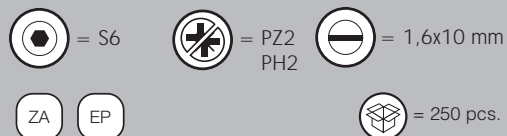

3010502000

## INTEGRATO G

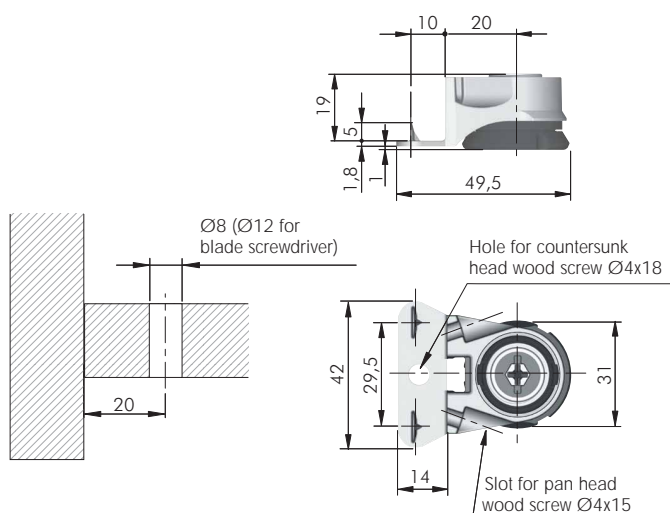

## ADJUSTMENT 0 - 12 mm

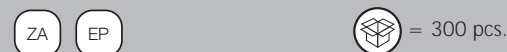

3010601000



3010603000



S6 mm



PZ2 - PH2



1,6x10 mm

S4/S6 mm

-

-

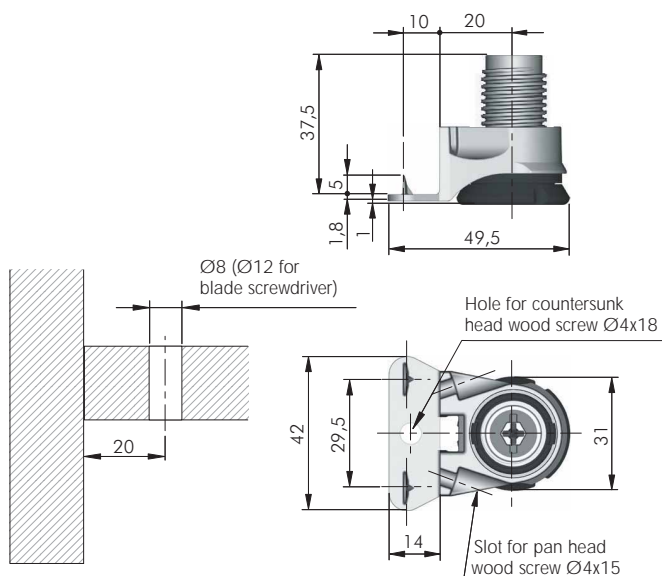

## ADJUSTMENT 0 - 25 mm

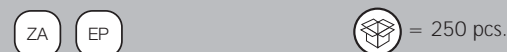

3010602000



3010604000



S6



PZ2 - PH2



1,6x10 mm

S4/S6 mm

-

-

## INTEGRATO ACCESSORY

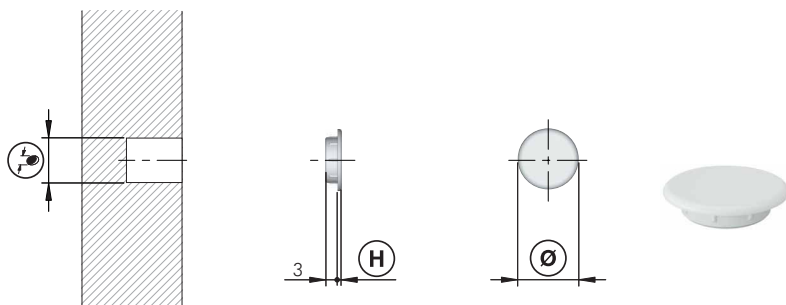

= Ø 8, Ø 12 mm				
EP				
23002010AB	Ø 8	Ø 11	1	5000
23002030AB	Ø 12	Ø 15	1	5000

## INTEGRATO FIXING ACCESSORIES

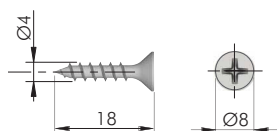

= Ø 3 mm				
ST	= 1000 pcs.			
60101580ZN				

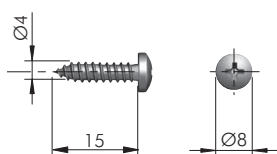

= Ø 3 mm				
ST	= 1000 pcs.			
60103230ZN				

## PLINTH CLIP FOR INTEGRATO

- For details refer to section "CONNECTINGS: PLINTH CLIP"

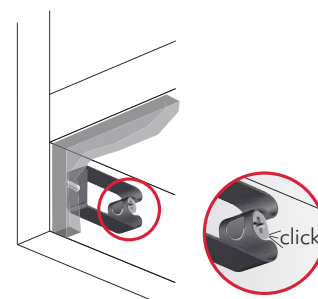
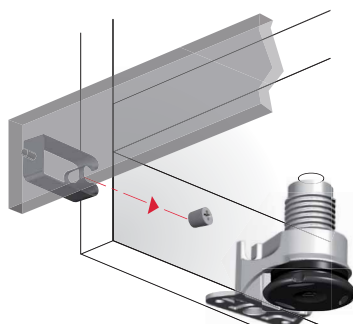
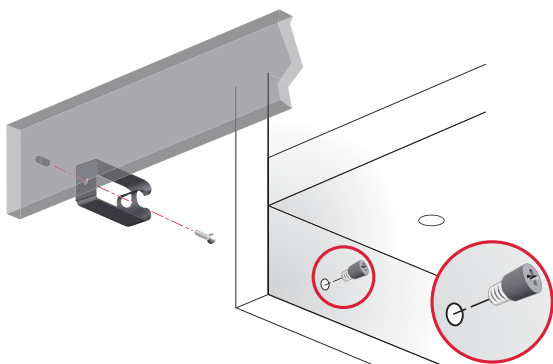

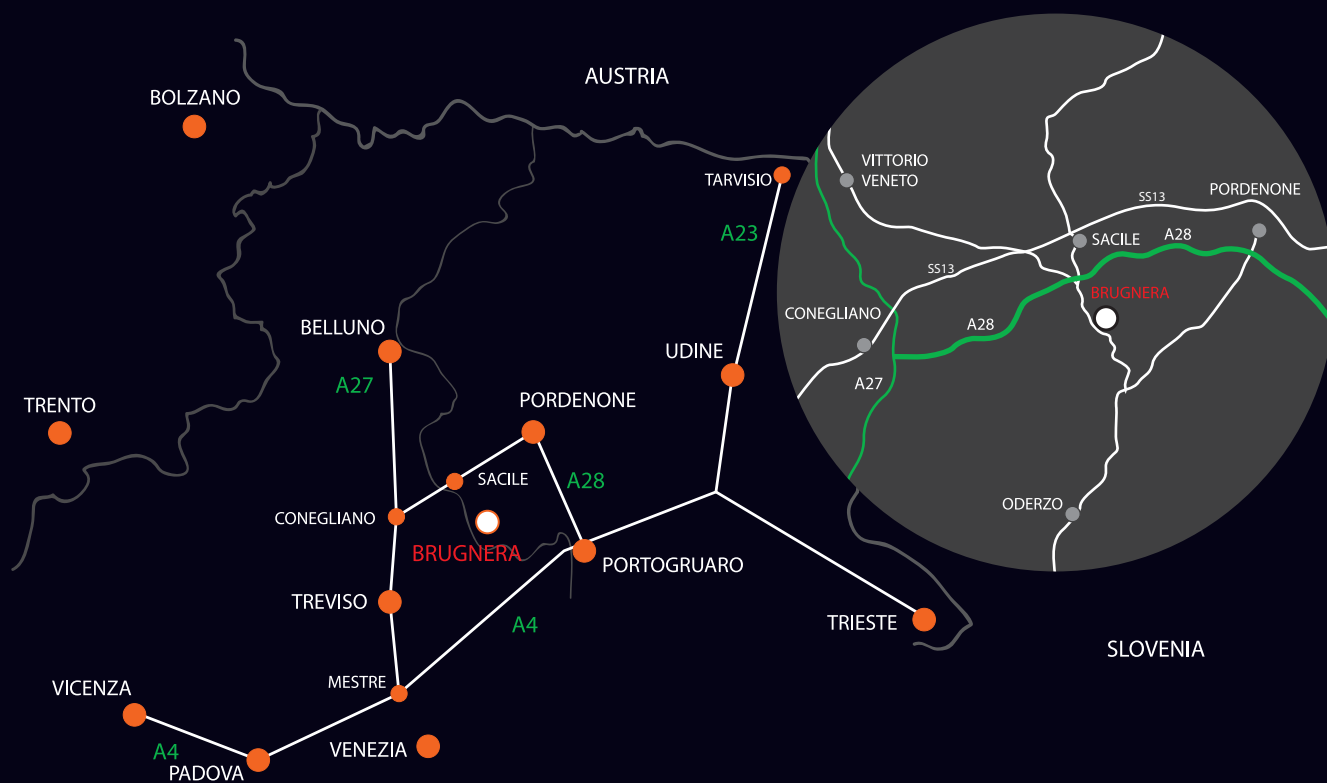

[www.italianaferramenta.com](http://www.italianaferramenta.com)